

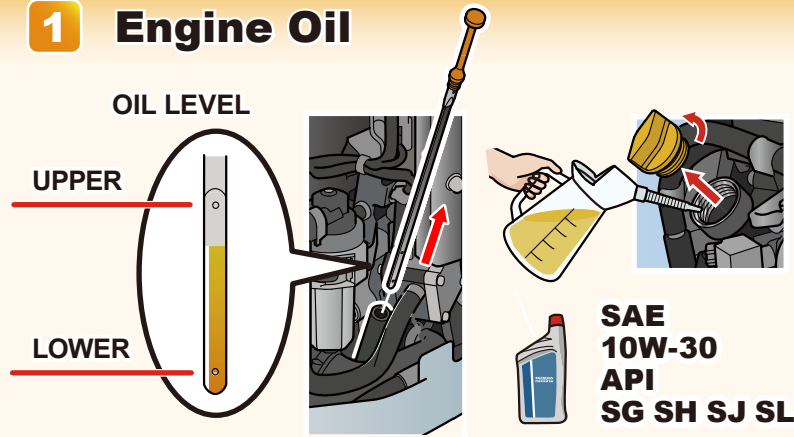

* Read and understand the Owner's Manual before operating the Outboard motor.

Before Operating

1 Engine Oil



2 Fuel Filter

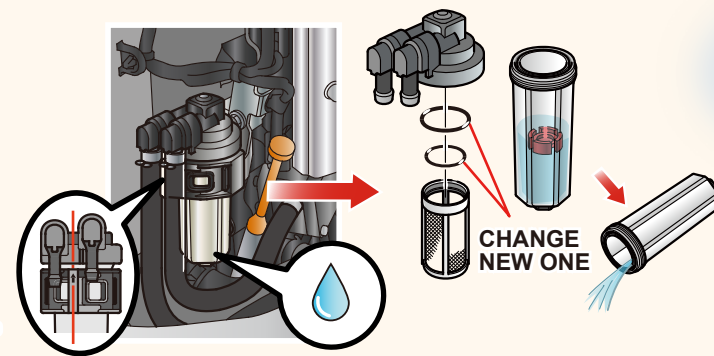

3 Anode Metal



4 Propeller & Cotter Pin

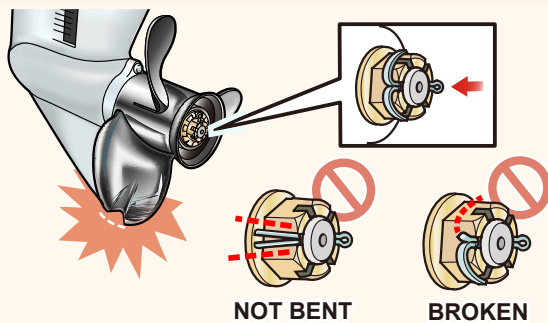

5 Battery

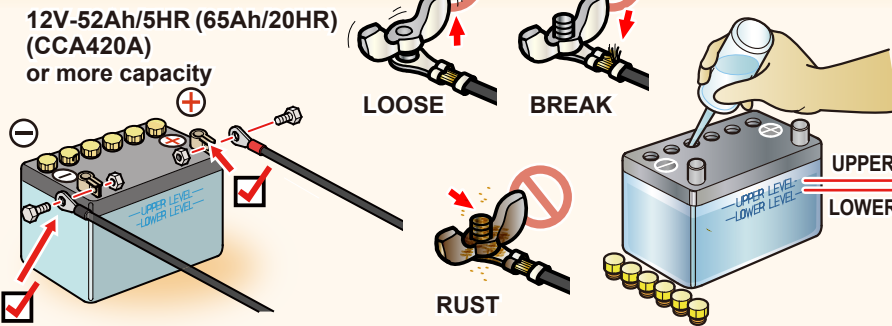

6 Fuel Line

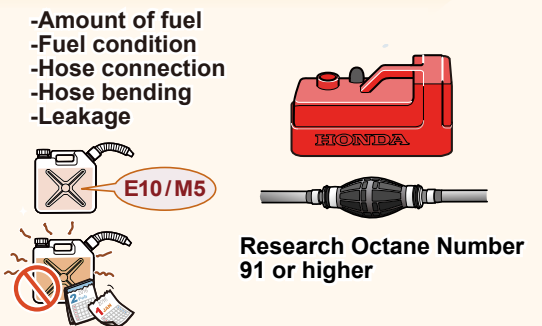

7 Condition

- Startability
- Sound, vibration
- Water circulation

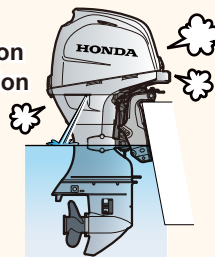

8 Emergency Stop Switch

Check that the emergency stop switch stops the engine.

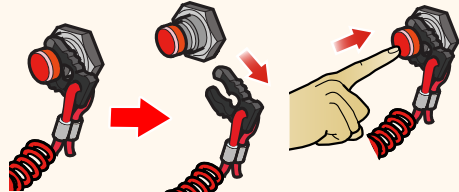

After Using

For a long time to use.

- 1 Cool down the engine by idling for a few minutes.
- 2 **Flush the engine for at least 10 minutes.**
- 3 Drain the flushing water completely without tilt-up.

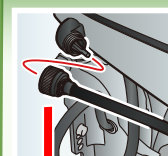

USE WATER HOSE JOINT
(ENGINE STOP)

OPTIONAL PARTS
Joint, Water Mouth
(19271-881-811)

USE HEADPHONE TYPE WASHER
(ENGINE RUN)

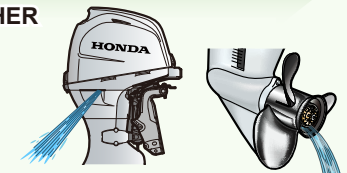
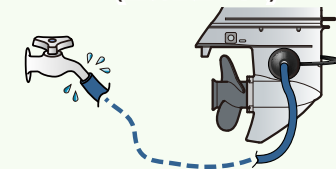



1 Engine Oil



SAE 10W-30
API SG SH SJ SL



WITH FILTER
REPLACEMENT
2.1 ℓ

W/O FILTER
REPLACEMENT
2.0 ℓ

UPPER

LOWER

2 Spark Plug

0.6–0.7 mm

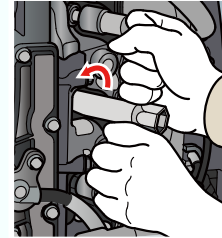

DR7EB (NGK)
X22ESR-UB
(DENSO)

3 Fuel Filter (Lo)

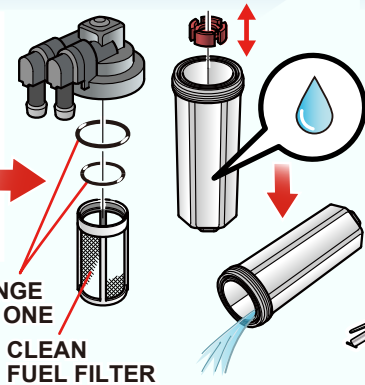
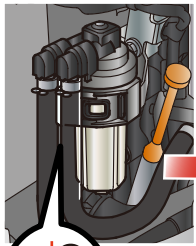

CHANGE
NEW ONE

CLEAN
FUEL FILTER

4 Propeller & Cotter Pin

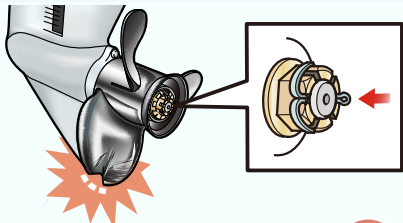

NOT BENT

BROKEN

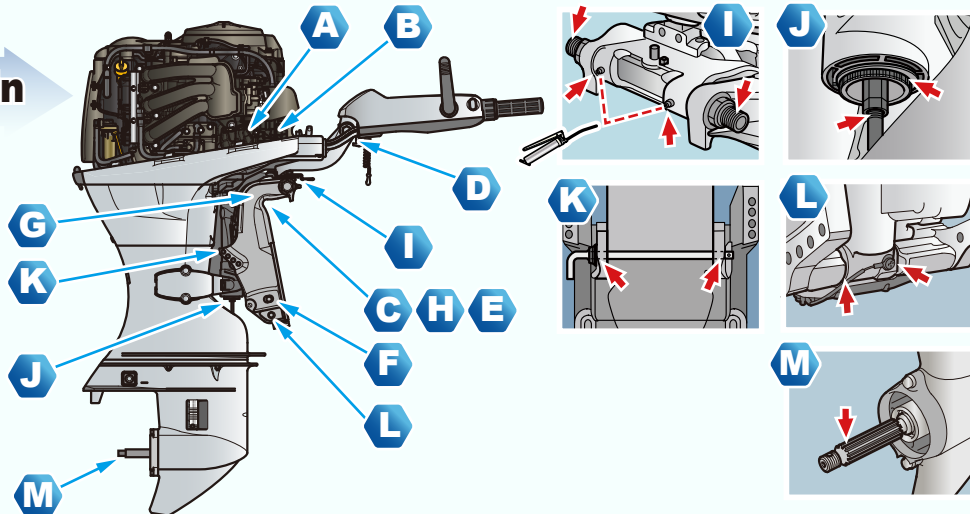

5 Grease

Water-resistant urea-based grease

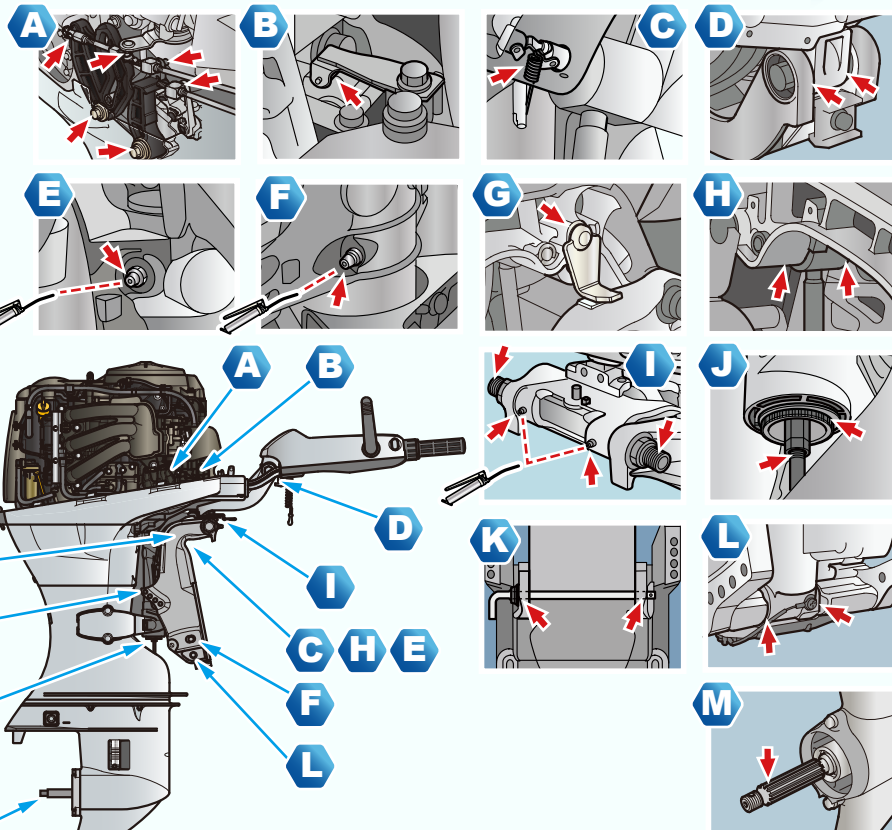

Before Operation
Regular Service

Maintenance Schedule

Regular Service Period	Before each use	First month or 20 Hours	Every 6 months or 100 Hours	Every year or 200 Hours	Every 2 year or 400 Hours
1 1 Engine oil	Check	Change	Change		
2 2 Spark plug			Check-adjust		
2 3 Fuel filter (Lo)	Check		Check		Change
3 3 Anode (Outer)	Check				
8 4 Emergency stop switch	Check				
4 4 Propeller	Check				
4 4 Cotter pin	Check				
5 5 Battery	Check				
5 5 Grease		Apply	Apply		
6 6 Fuel line	Check				

Inspection Items By The Dealer

Inspection Item	Every 2 years	Replace if necessary
Fuel line		Change
Valve clearance		Check-adjust
Idle speed	Adjust	
Throttle linkage	Adjust	
Engine oil filter	Change	
Breather tube	Check	
Timing Belt	Check	
Thermostat	Check	
Water pump	Check	
Boils and nuts	Check	
Gear case oil	Change	
Fuel filter (Hi)	Check	Change
Power Trim/Tilt	Check	
Shift cable	Check	
Anode (Inner)	Check	

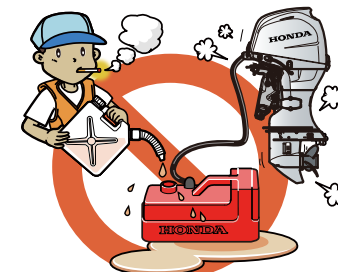

To use safely, read the owner's manual before operating the outboard motor.

